

Technical Manual

JBL2206H/J

SPECIFICATIONS



ACOUSTIC & ELECTRICAL SPECIFICATIONS:

- Nominal Impedance: 8 ohm
- Power Capacity: 600W Continuous Pink Noise
- Frequency Range: 45 Hz to 3.5 kHz
- Sensitivity: 95 dB SPL*
- Crossover Frequencies: N/A

SYSTEM COMPONENTS:

- Cabinet: N/A
- Grille: N/A
- Low Frequency Transducer: 300mm (12 in.) Cone Transducer (2206H)
- DC Resistance: 5.3 ohm \pm 10% Aluminum Wire (H)
9.3 ohm \pm 10% Aluminum Wire (J)

AURAL SWEEP TEST SPECIFICATIONS:

- A. L.F. Aural Sweep Test: 10.0V Input, 20 Hz to 3.5 kHz

PHYSICAL SPECIFICATIONS:

- Enclosure Dimensions: 311mm x 311mm x 127mm D
(12.25 x 12.25 x 5.0 in. D)
- Shipping Weight: 18.5 lbs. (8.4 kg)

WARRANTY INFORMATION:

- Refer to the Warranty Statement packed with each product.

*1 Watt (2.83 V RMS) @ 1 Meter

PACKAGE

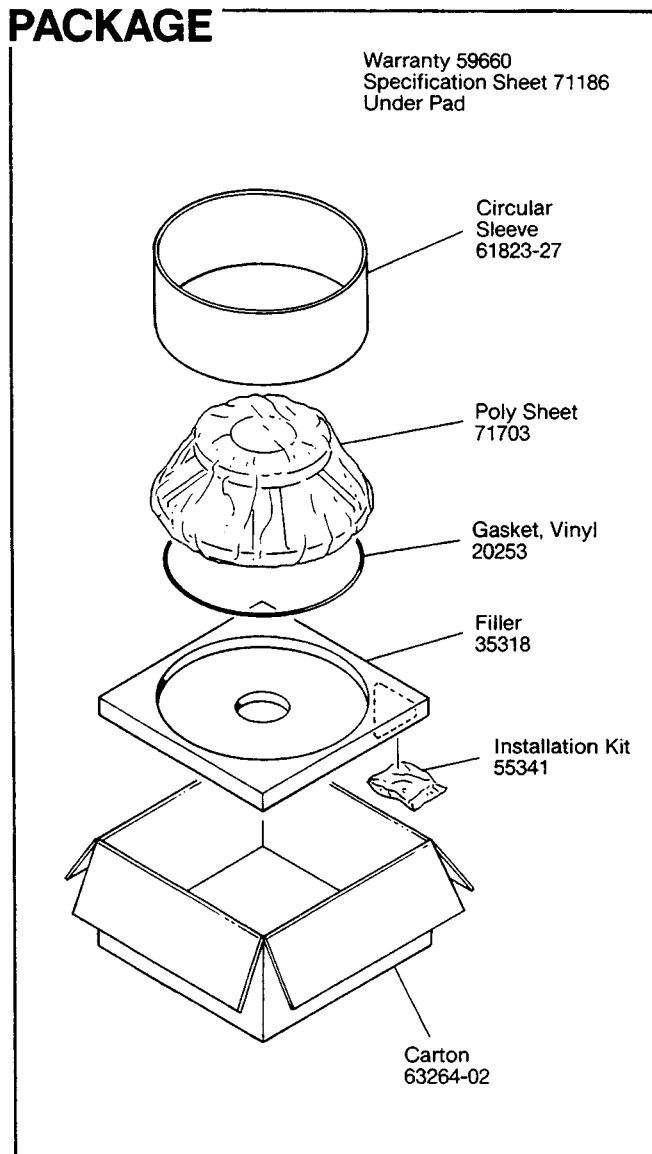

COMPONENT VIEW

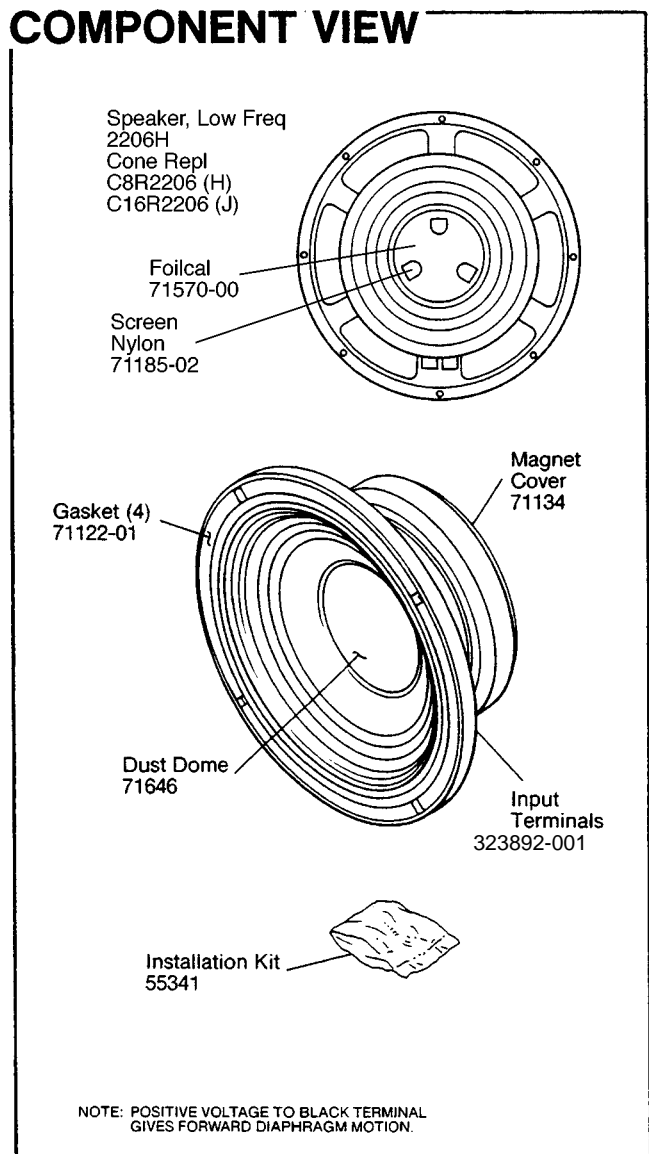

JBL2206H/J REV E

JBL2206H/J

THESE DRAWINGS AND SPECIFICATIONS ARE THE PROPERTY OF JBL. UNLESS INDICATED OTHERWISE, ALL DIMENSIONS ARE IN INCHES. NO PARTS OR EQUIPMENT SHALL BE REPRODUCED OR SALES OF APPARATUS WITHOUT WRITTEN PERMISSION.

MECHANICAL DRAWING

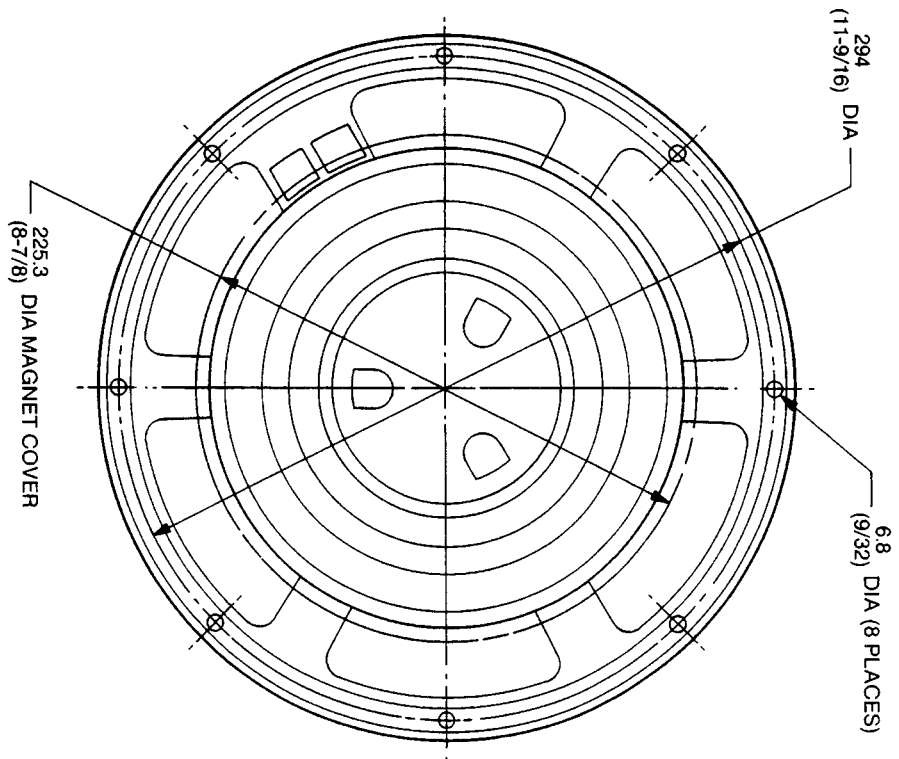
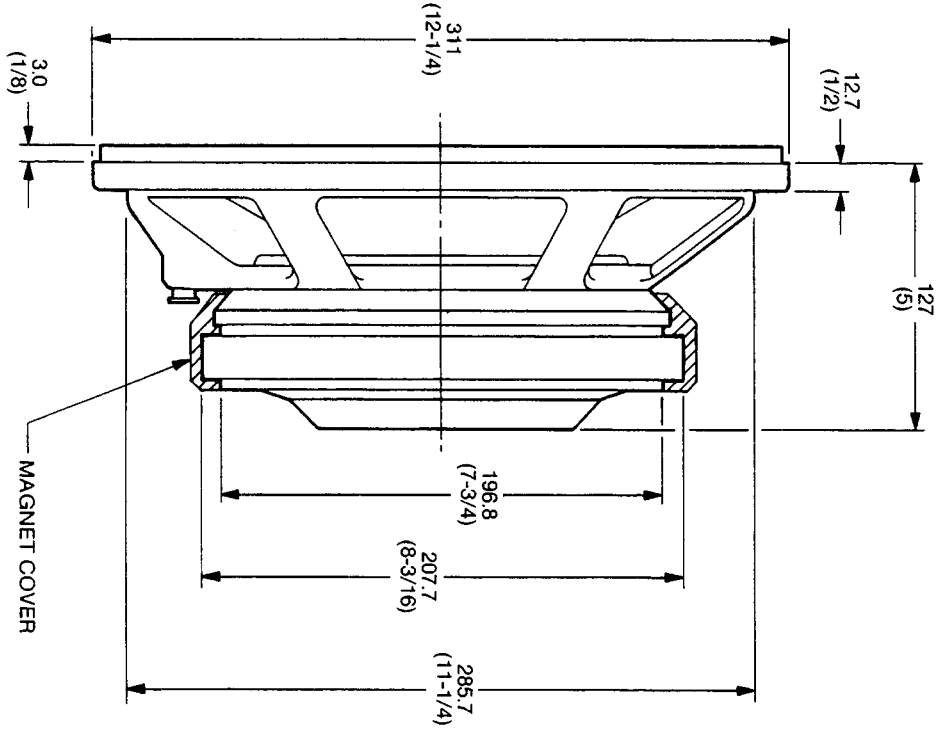

ALL DIMENSIONS ARE REF. ONLY
NOTE: DIMENSIONS IN () ARE IN INCHES

JBL2206H/J