

Technical Manual

JBL2220H/J

SPECIFICATIONS



ACOUSTIC & ELECTRICAL SPECIFICATIONS:

- Nominal Impedance: 8 ohm (H)
16 ohm (J)
- Power Capacity: 200W Continuous Program
- Frequency Range: 40 Hz to 2 kHz
- Sensitivity: 101 dB SPL*
- Crossover Frequencies: N/A

SYSTEM COMPONENTS:

- Cabinet: N/A
- Grille: N/A
- Low Frequency Transducer: 380mm (15 in.) Cone Transducer (2220H/J)

*1 Watt (2.83 V RMS) @ 1 Meter

SYSTEM COMPONENTS: (cont'd)

- DC Resistance: 5.8 ohm \pm 10% Copper Wire (H)
13.2 ohm \pm 10% Copper Wire (J)

AURAL SWEEP TEST SPECIFICATIONS:

- A. L.F. Aural Sweep Test: 14.0V Input, 20 Hz to 1.2 kHz

PHYSICAL SPECIFICATIONS:

- Enclosure Dimensions: 388mm x 388mm x 146mm D
(15.26 x 15.26 x 5.75 in. D)
- Shipping Weight: 27.75 lbs. (12.6 kg)

WARRANTY INFORMATION:

- Refer to the Warranty Statement packed with each product.

PACKAGE

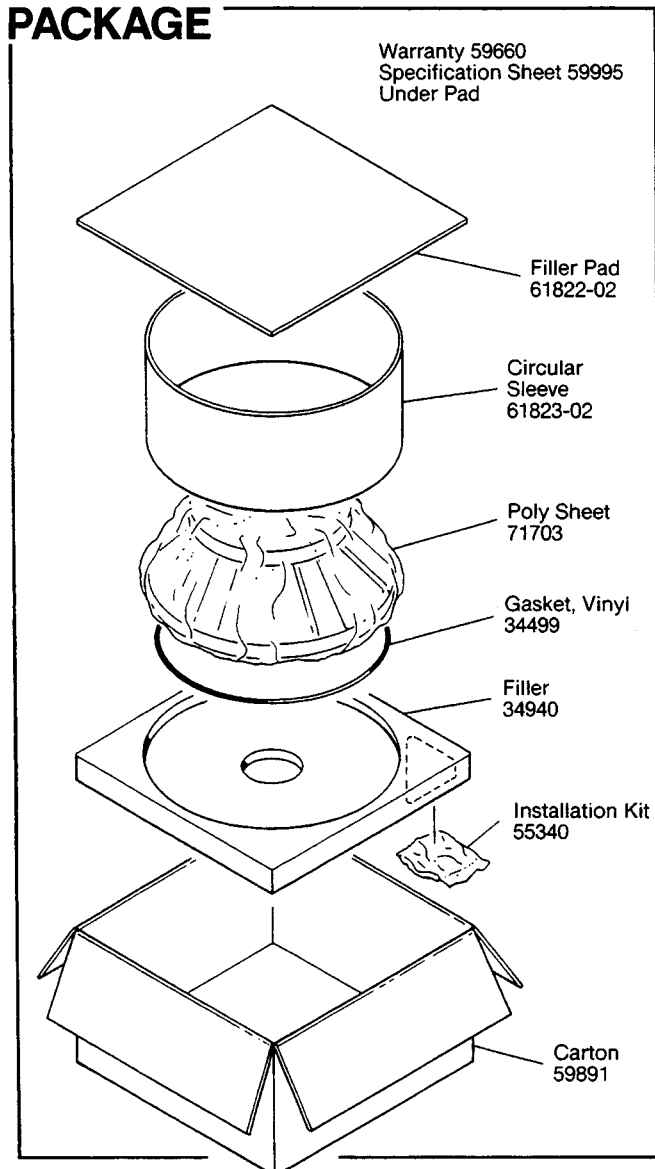

COMPONENT VIEW

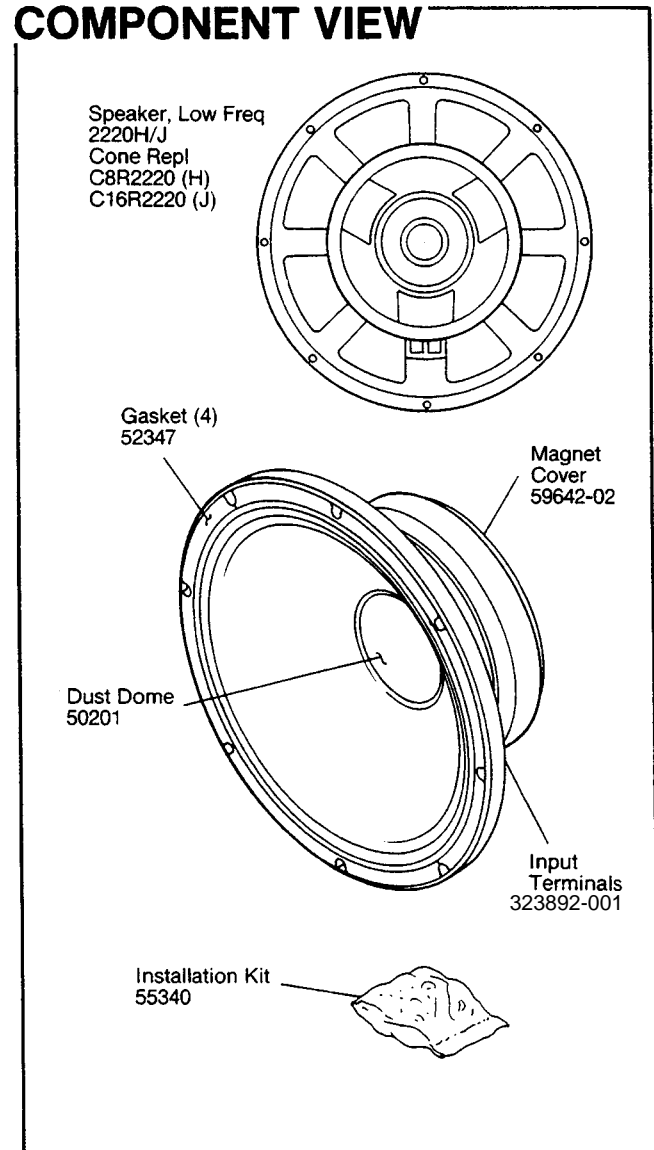

JBL2220H/J REV C

JBL2220H/J

MECHANICAL DRAWING

THESE DRAWINGS AND SPECIFICATIONS ARE THE PROPERTY OF JBL INCORPORATED. THEY ARE ISSUED IN STRICT CONFIDENCE AND SHALL NOT BE REPRODUCED OR COPIED OR USED AS THE BASIS FOR MANUFACTURE OR SALE OF ANYTHING WITHOUT WRITTEN PERMISSION.

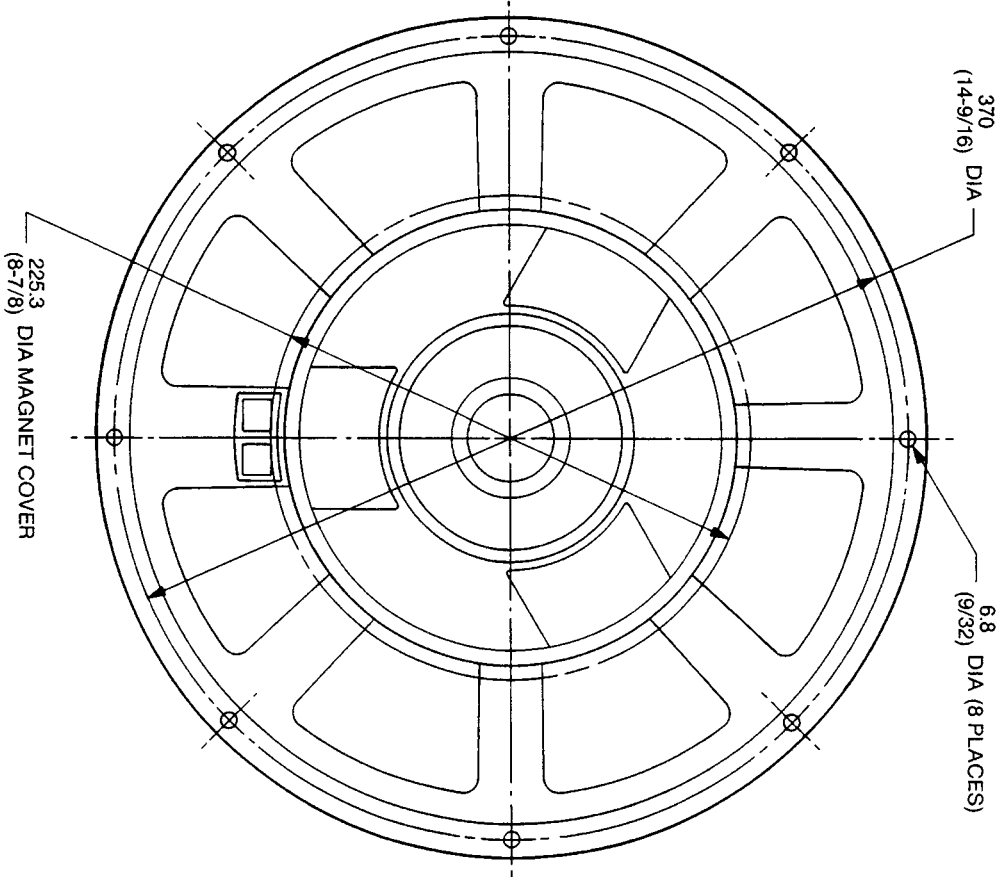
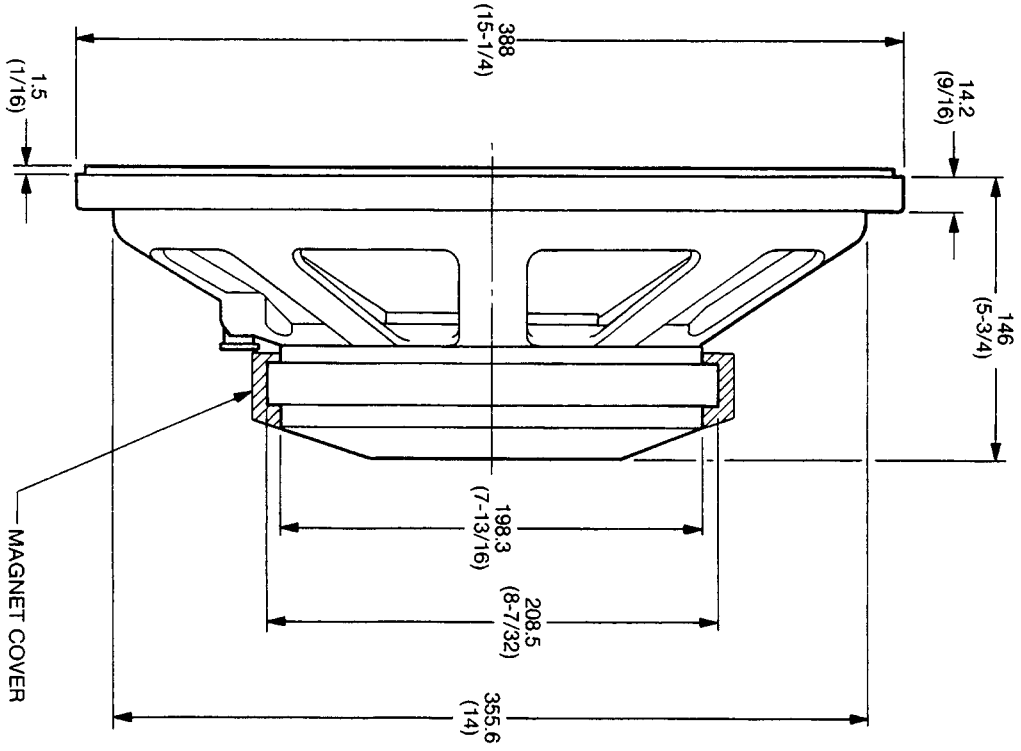

ALL DIMENSIONS ARE REF. ONLY
NOTE: DIMENSIONS IN () ARE IN INCHES

JBL2220H/J