

Technical Manual

JBL E140-8, (-16)

SPECIFICATIONS



ACOUSTIC & ELECTRICAL SPECIFICATIONS:

- Nominal Impedance: 8 ohm, 16 ohm
- Power Capacity: 400W Continuous Program
200W Continuous Sine Wave²
- Frequency Range: 40 Hz to 2.5 K
- Sensitivity: 100 dB SPL*
- Crossover Frequencies: N/A

SYSTEM COMPONENTS:

- Cabinet: N/A
- Grille: N/A
- Low Frequency Transducer: 380mm (15 in.) Cone Transducer (E140-8, -16)
- DC Resistance: 5.5 ohm ±10% Copper Wire (-8)
13.3 ohm ±10% Copper Wire (-16)

AURAL SWEEP TEST SPECIFICATIONS:

- L.F. Aural Sweep Test: 7.0V Input, 20 Hz to 1.2 kHz (-8)
14.0V Input, 20 Hz to 1.2 kHz (-16)

PHYSICAL SPECIFICATIONS:

- Enclosure Dimensions: 387mm x 387mm x 137mm D
(15.25 x 15.25 x 5.38 in. D)
- Net Weight: 22-1/4 lbs. (10.1 kg.)

WARRANTY INFORMATION:

- Refer to the Warranty Statement packed with each product.

*1 Watt (2.83 V RMS) @ 1 Meter (-8)

*1 Watt (4.0 V RMS) @ 1 Meter (-16)

PACKAGE

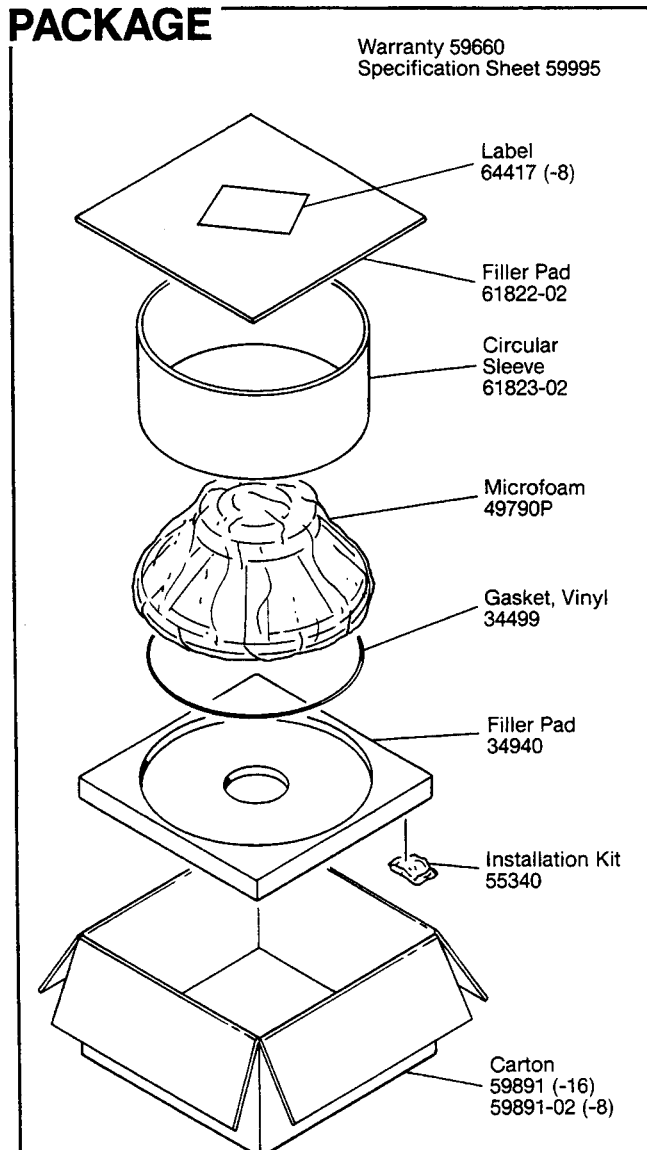

COMPONENT VIEW

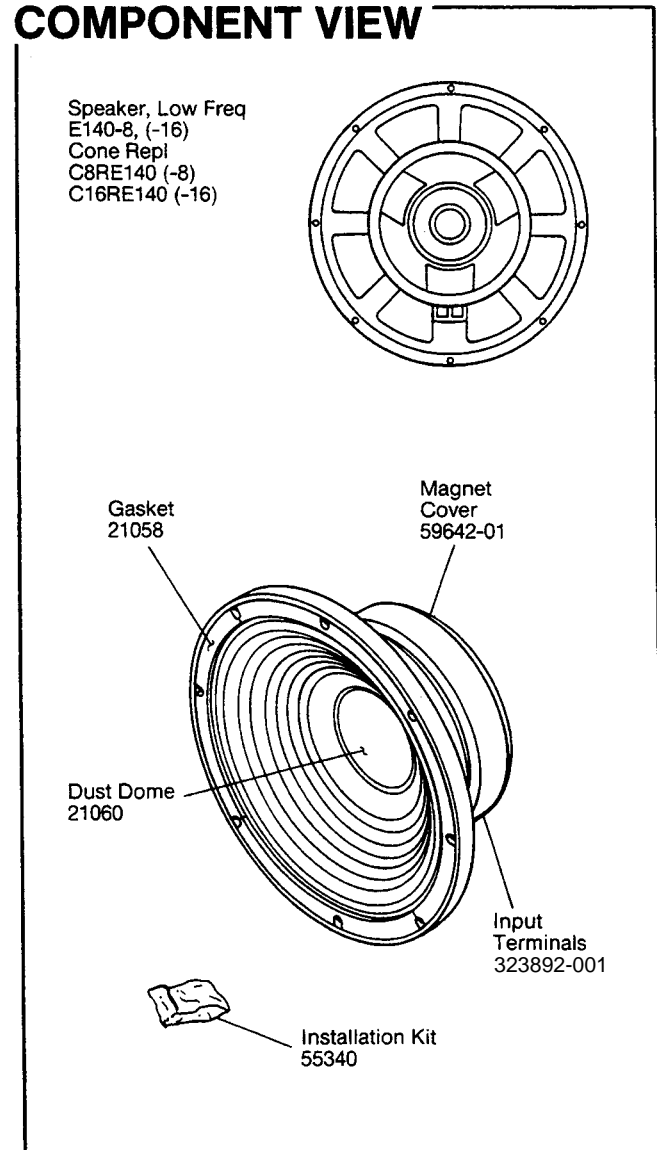

JBL E140-8, (-16) REV B

JBL E140-8, (-16)

MECHANICAL DRAWING

THESE DIMENSIONS AND SPECIFICATIONS ARE THE PROPERTY OF JBL INCORPORATED. THEY ARE ISSUED IN STRICT CONFIDENCE AND SHALL NOT BE REPRODUCED, COPIED OR USED AS THE BASIS FOR MANUFACTURE OR SALE OF APPARATUS WITHOUT WRITTEN PERMISSION.

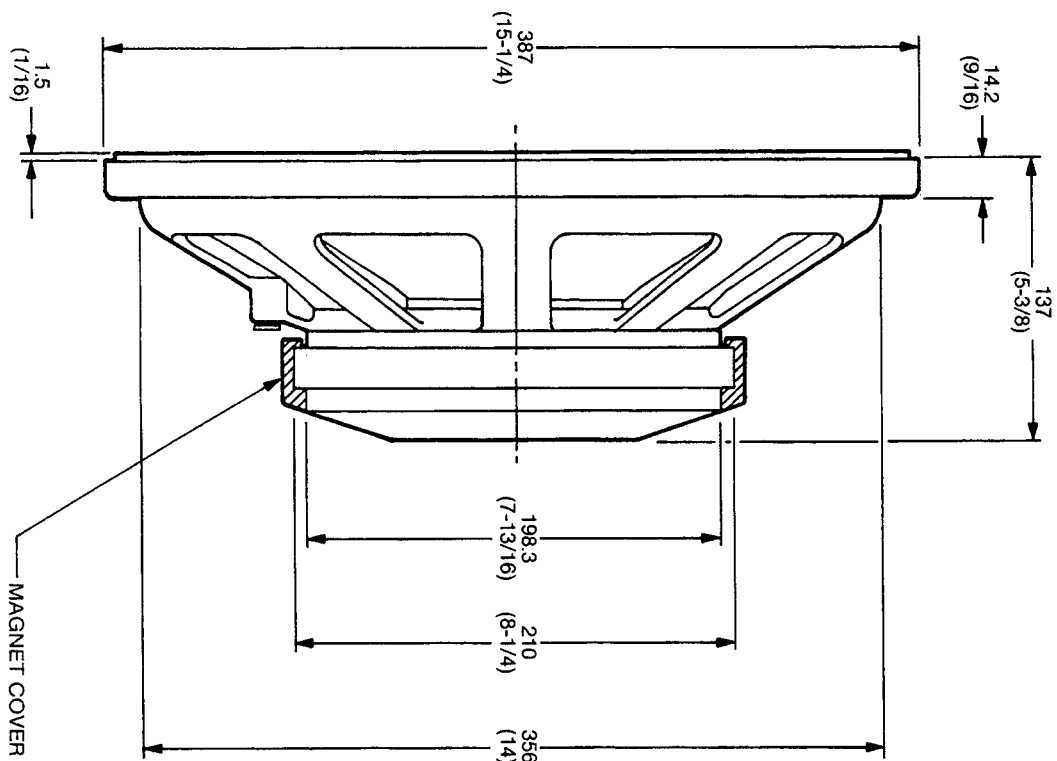

ALL DIMENSIONS ARE REF. ONLY
NOTE: DIMENSIONS IN () ARE IN INCHES

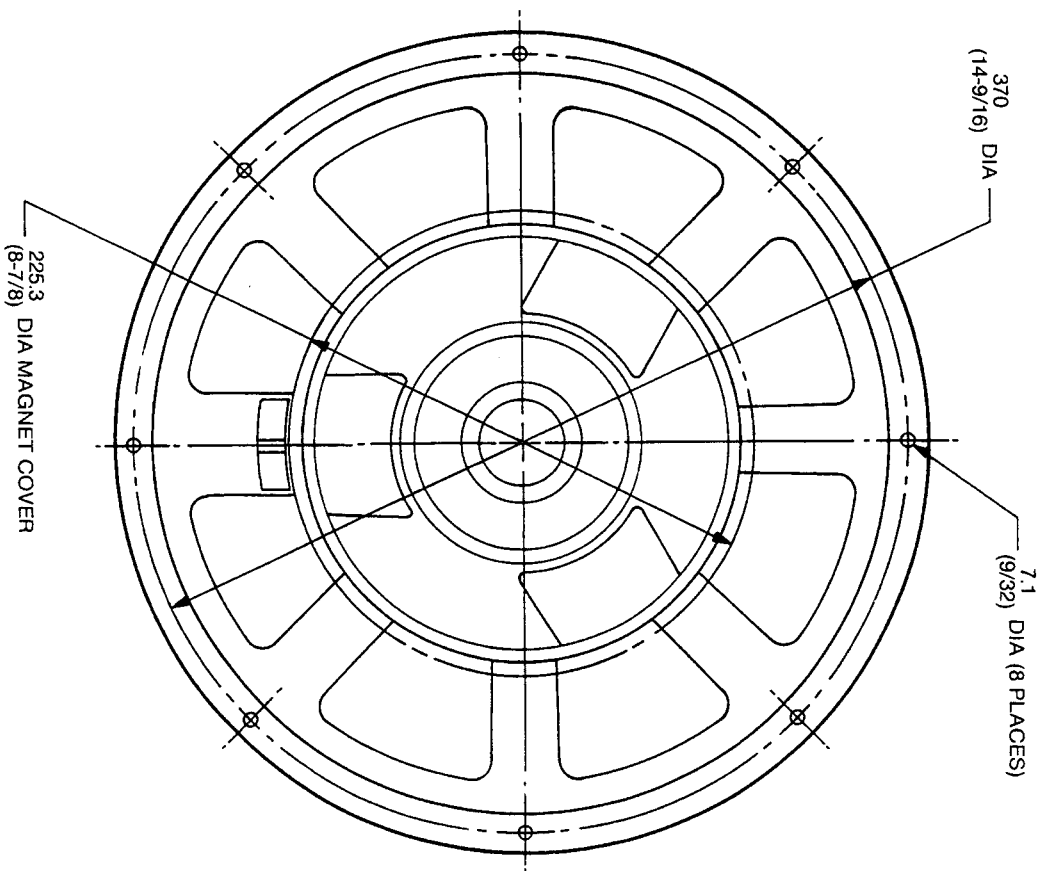

JBL E140-8, (-16)